

# WK1207A General Specification

## WK1207A Mini Led Wall Washer

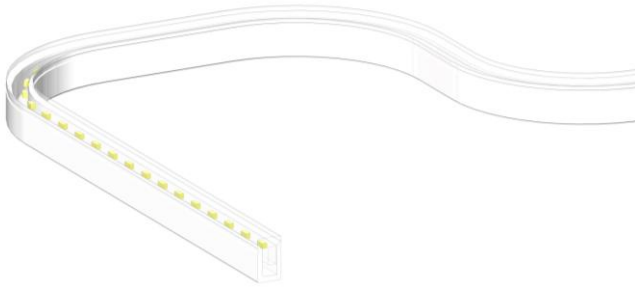

### 1. Features

- ✦ Side bending and Top lighting
- ✦ Enhanced SMT LED inside
- ✦ Dual-color silicone extrusion
- ✦ UV and yellowish resistant
- ✦ IP67 and salt-mist proof
- ✦ L70B50 > 50,000hrs
- ✦ UL 94 V-0
- ✦ Easy installation and re-connect accessories
- ✦ Min. bending radius 3cm

### 2. Applications

- ✦ Neon tube light source
- ✦ Building and sign outline lighting
- ✦ General and cove lighting
- ✦ Ships, boats and trucks outline lighting
- ✦ Bathroom, spa room lighting

### 3. Dimensions

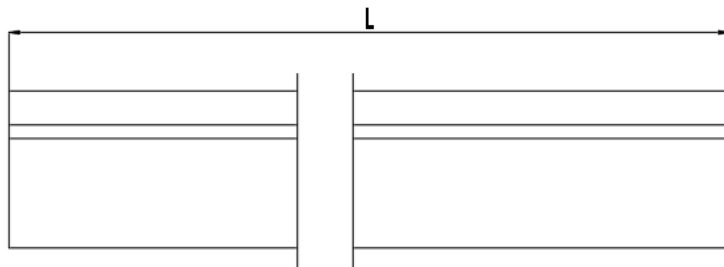
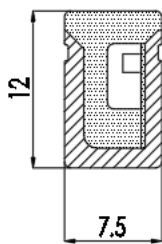

*Notes:*

1. Unit: mm
2. Strip L = 5meters for 24V product in standard configuration

### 4. Environmental and Application Conditions

Ambient temperature range (TA on free air)	-40°C ~..+55°C
Operating (case) temperature range (TC)	-40°C ~..+65°C
Storage temperature range	-40°C ~..+85°C
IP rating	IP67/40



# WK1207A General Specification

## 5. Electrical parameters

Item	WK1207A
Supply voltage range	24.0±1.0 VDC
Supply Current range (per meter)	Typ.500mA
Power range (per meter)	Typ. 12W
ESD protection	Contact 4KV, Air 8KV
Max. length for single end power-in	5 meters
Max. length for two ends power-in	7.5 meters
Cutting unit length	50mm

## 6. Optical parameters

Part No.	Colorimetric Parameters		Product Flux	CRI
	Color	Value	Typ. Lumen	
WK1207A	White	6500K	1020 lm/m	Ra 80
	White	5000K	1020 lm/m	Ra 80
	White	4000K	1020 lm/m	Ra 80
	White	3500K	950 lm/m	Ra 80
	White	3000K	950 lm/m	Ra 80
	White	2700K	900lm/m	Ra 80

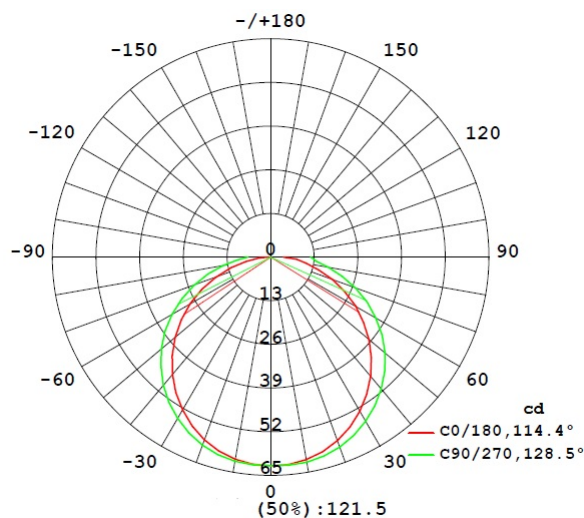

# WK1207A General Specification

## 7. Connectors

### 7.1 IP40 Connector and end-cap (Side feed-in and End feed-in cable)

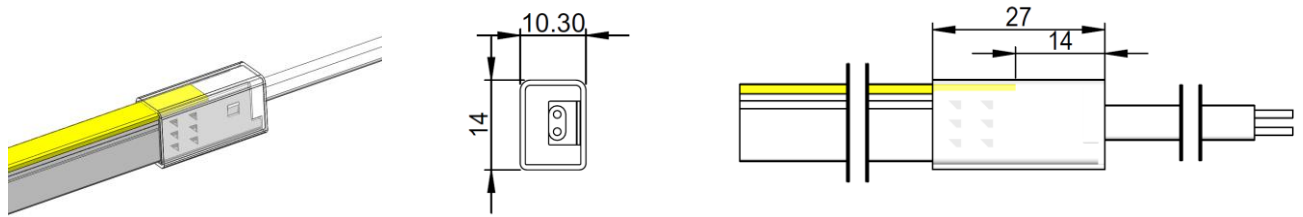

### 7.2 IP67 Molded connector for Side&End feed-in cable

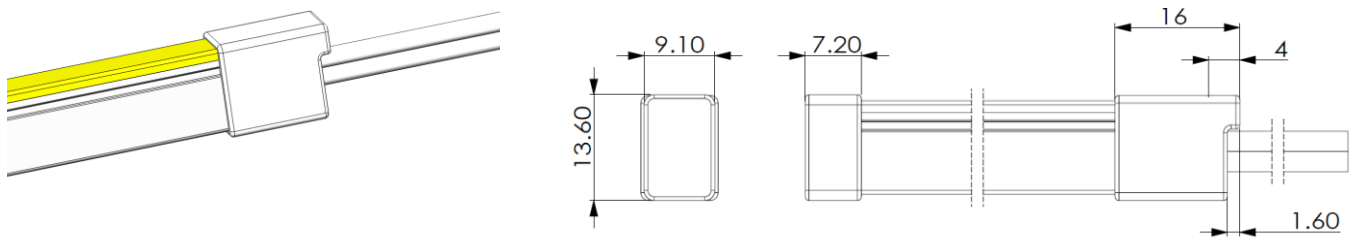

## 8. Wiring

Connector cable refer to below drawing.

Mold cable will be 2 white wires(refer to label on wires)

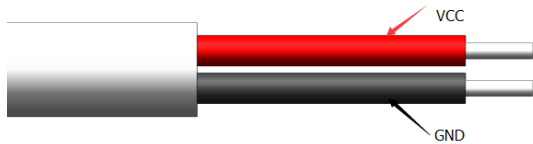

## 9. Installation accessories

### 9.1 AL profile (1mtr/pcs) & AL clip (30mm/pcs)

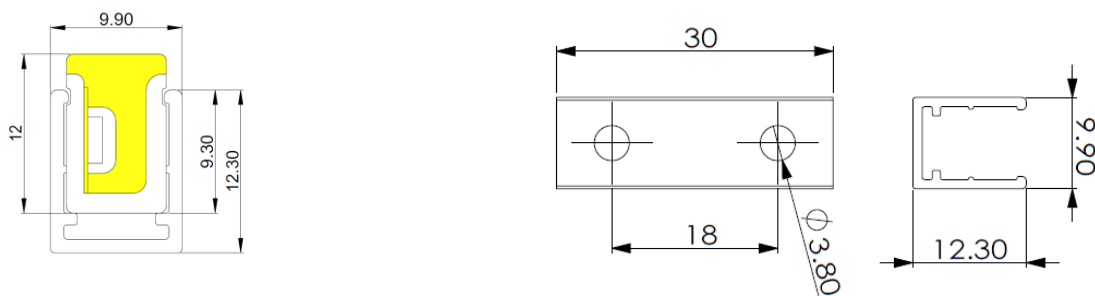

# WK1207A General Specification

## 9.2 PC clips

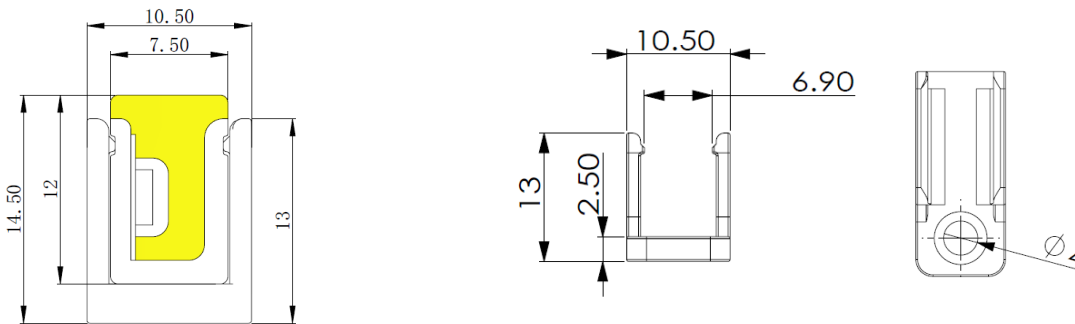

## 10. Attention

- The LED neon itself and all its components may not be mechanical stressed.
- Please ensure that the power supply is adequate power to operate the total load. Only qualified personnel should be allowed to perform installations.
- The design of the housing should be according to the IP standards in the application.
- If surge protection structure not within power supplier, a lightning protector should be needed additionally.
- Before cutting and making reconnection, please read the user manual, and please ensure you have read and fully understand it.
- Please do not twist the product and do not bend it in wrong direction, the only bending direction as following:

