



WK-IF-F1323 uses TPU materials with good light transmittance, crystal clear appearance, stainless steel fasteners, very convenient installation. Protection grade IP68, the highest protection grade, can be used outdoors, underground for a long time. Flame retardant grade V-0, the highest flame retardant grade, from the fire extinguish, superior safety performance. UV resistant, not easy to yellowing, no cracking. Good weather resistance, high temperature and cold resistance, can be used at minus 40°C. Through salt fog test, it can be used in coastal areas with high salt fog for a long time.

INFLOOR FLEXIBLE NEON STRIP

WK-IF-F1323



Parameters

Name	INFLOOR FLEXIBLE NEON STRIP		
Model	WK-IF-F1323		
Color	W	R/G/B/W	RGB
Power	10W/m	7.5W/m	14W/m
Voltage	DC24V		
LED quantity	120pcs/m	96pcs/m	60pcs/m
Pixel qty.	/	8pixels/m	10pixels/m
Control mode	Turn ON / OFF	SPI	SPI
IP rating	IP68		
Fire proof	V-0 grade		
Beam angle	110°		
Size	5010mm*13mm*23mm (5m/roll)		
Working Temperature	-20°C To +55°C		
Warranty	5 years		
N.W.	810g/5m or 205g/m		

NEW Product

Flexible Uniform Light-Emitting LED Strip Light

>>>

With Comfortable and Soft Light Color

Uniform Light-emitting Avoid Direct Light-emitting From Leds



- ① With Fat-cut Illuminated Tip Design
- ② Both Ends Merged, Seamless Splicing
- Vacuum high temperature integral molding, solid filling
- reflective light emitting, the light is transparent and more uniform and soft, no glare
- It can be used for a long time in outdoor, underground, seaside and other environments



Product Features and Functions

• Side-emitting Lighting

- It does not need to install a uniform plate or a second slot for installation at close distance, just do installation directly
- The side waterproof outlet method effectively optimizes the product size and realizes ultra-narrow installation



Features and Applications:



★ Waterproof grade IP68, Can be used in outdoor



★ integral molding, flexible and uniform light-emitting



★ Intelligent control



★ Can be used for indoor and outdoor lighting

Dimension

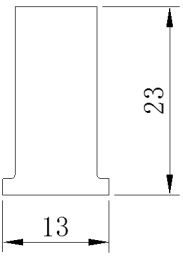

Fixture dimension

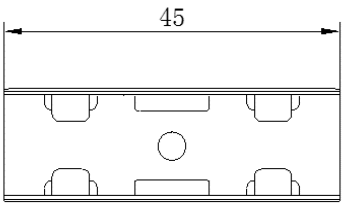
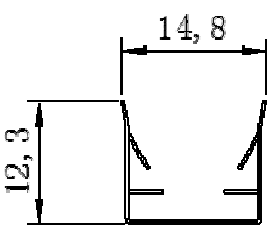

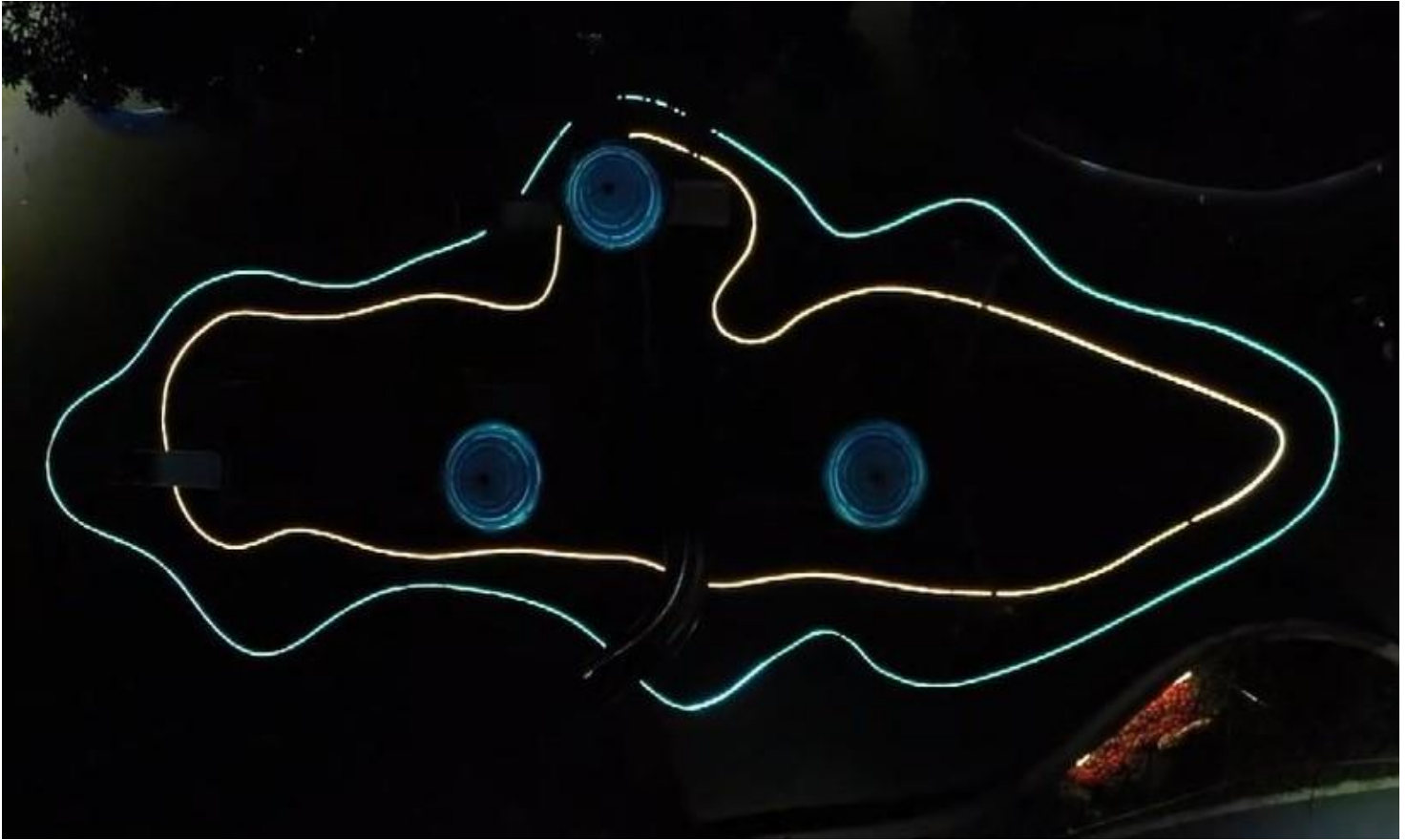

Remarks

- 1.The test environment temperature for the data provided in this specification is $25\pm 2^{\circ}\text{C}$.
- 2.The parameters provided in this specification are all based on standard products, there will be some errors in the actual parameters of the product,please subject to the actual product.
- 3.If you choose different color temperatures,colors etc., the optical parameters will fluctuate to a certain extent.
- 4.For the specific installation arrangements and precautions of the product, please refer to the product manual.
- 5.The illustrations in this specification are all schematic diagrams, the actual product may vary, please subject to the actual product.
- 6.This product is subject to any changes without notice.
- 7.The final interpretation right of this specification belongs to WK LED BV.